

Upright Freezer Top View

FREEZER SPECIFICATIONS		
CAPACITY	13 CUBIC FEET	
STYLE	UPRIGHT	
NET WEIGHT	725 LBS.	
SHIPPING WEIGHT	850 LBS.	
INTERIOR DIMENSIONS		
INTERIOR WIDTH	20.0"	(50.8 cm)
INTERIOR DEPTH	22.0"	(55.9 cm)
INTERIOR HEIGHT	51.25"	(130 cm)
EXTERIOR DIMENSIONS		
EXTERIOR WIDTH	35.0"	(88.9 cm)
EXTERIOR DEPTH	34.5"	(87.6 cm)
EXTERIOR HEIGHT	79.5"	(201.9 cm)
EXTERIOR CRATED DIMENSIONS		
CRATED WIDTH	46.0"	(116 cm)
CRATED DEPTH	43.0"	(109 cm)
CRATED HEIGHT	86.0"	(218 cm)

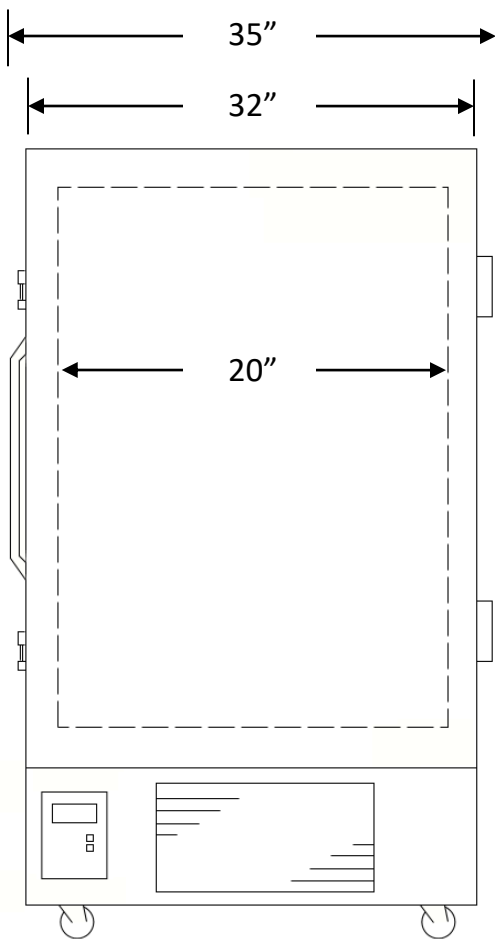

Upright Freezer Front View

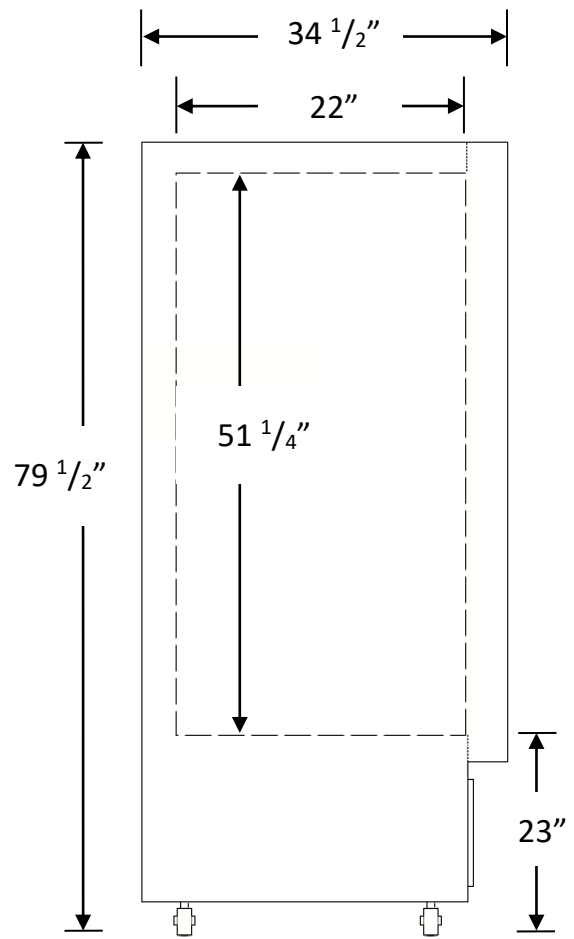

Upright Freezer Side View