

MODEL NU40-18

18 CUBIC FOOT ULTRA LOW TEMPERATURE FREEZER

| | WIDTH | DEPTH | HEIGHT | WIDTH | DEPTH | HEIGHT |
|---------------------|-------|-------|----------|--------|--------|--------|
| INTERIOR DIMENSIONS | 23 IN | 26 IN | 51.25 IN | 58 CM | 66 CM | 130 CM |
| EXTERIOR DIMENSIONS | 36 IN | 36 IN | 79.5 IN | 91 CM | 91 CM | 201 CM |
| CRATED DIMENSIONS | 46 IN | 43 IN | 86 IN | 116 CM | 109 CM | 218 CM |

NOTE THAT SHELVES ARE SHOWN IN DEFAULT CONFIGURATION, AND CAN BE ADJUSTED IN 1" INCREMENTS

SIDE VIEW

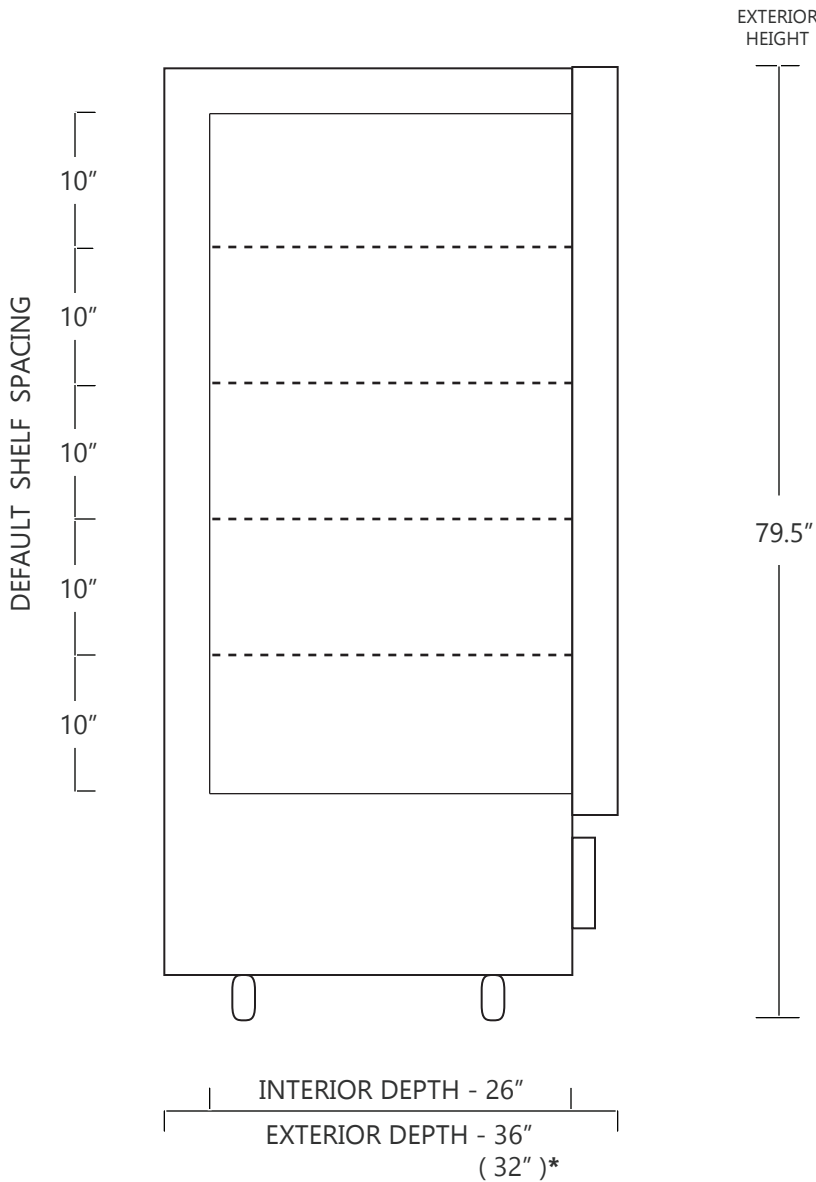

FRONT VIEW

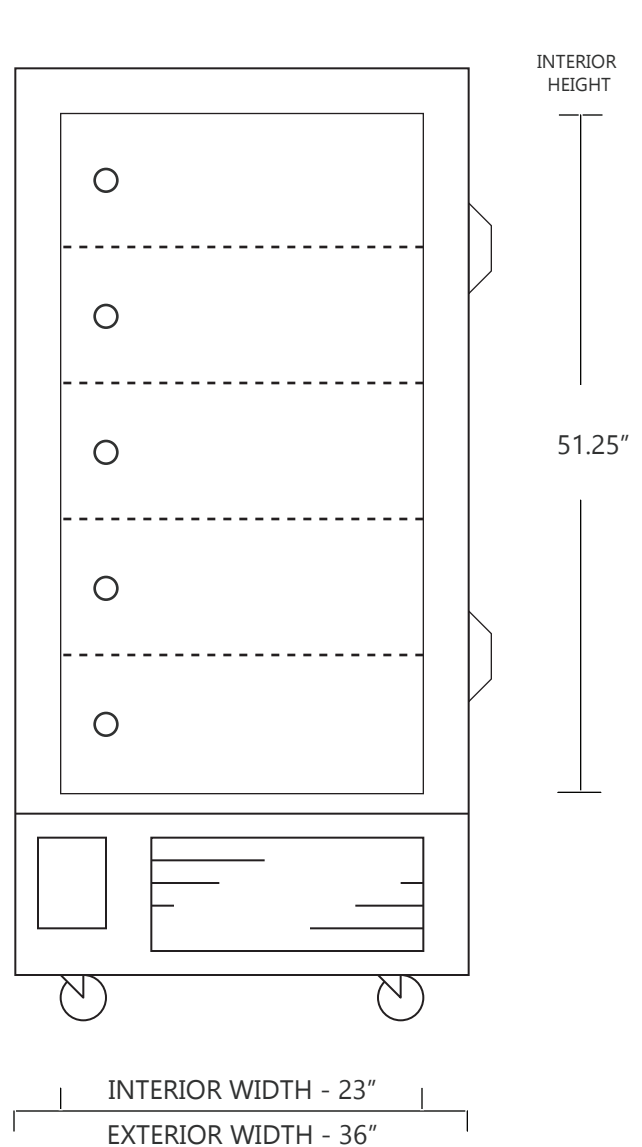

*TO PASS THROUGH DOORWAYS, THE DOOR CAN OPEN A FULL 180°, TO REDUCE THE UNIT EXTERIOR DEPTH TO 32"

SO-LOW

WWW.SO-LOW.COM



NET WEIGHT : 725 LBS.
SHIPPING WEIGHT: 900 LBS.

SHIPPING OPTIONS

- DOCK-TO-DOCK DELIVERY (REQUIRES FORKLIFT OR PALLET JACK)
- DOCK-TO-DOCK DELIVERY WITH LIFTGATE (REQUIRES FORKLIFT OR PALLET JACK)
- INSIDE DELIVERY (WHITE GLOVE DELIVERY)